



Environment
Agency



Rotherham Renaissance Flood Alleviation Scheme

James Mead
Project Manager
15th February 2011



Rotherham Flood Alleviation Scheme

- ➔ Pioneering scheme combining flood risk reduction and regeneration
- ➔ Innovative delivery by Rotherham Council
- ➔ Case study for development of PPS25 and External Funding Policy of the Environment Agency
- ➔ Winner of BURA Waterways Award and Commended by the ICE
- ➔ Exemplar environmental performance in delivery and partnership with Sheffield & Rotherham Wildlife Trust

Templeborough November 2000

Rotherham Town Centre

River Rother

Agency office

Centenary Riverside

River Don



History

- ➔ Rotherham lies on the River Don at the River Rother confluence
- ➔ Periodic flooding significantly in Autumn 2000 and summer 2007
- ➔ Over 100 properties and key infrastructure at risk
- ➔ The urban centre of Rotherham is identified as a **Regeneration Priority Area** in the *Regional Spatial Strategy for Yorkshire & Humber*

Rotherham July 2007



Regeneration

- ⇒ *Masterplan Rotherham* has the key aims of
 - ⇒ “making the river & canal a key part of the Town’s future”
 - ⇒ “a broadly based, dynamic local economy with a vibrant town centre as its focus, capitalising on new public spaces and a new riverside”
- ⇒ Management of flood risk within Rotherham is a fundamental element of providing continuity to the town’s regeneration

Timeline

- ⇒ In September 2003 the Environment Agency was invited to join a **Partnership** with Rotherham MBC, Renaissance South Yorkshire and Yorkshire Forward to develop **WSP's** outline design
- ⇒ Appraisal work carried out through 2004/5 indicated insufficient flood defence benefits for the Environment Agency to develop the scheme
- ⇒ RMBC secured **development funding** through Yorkshire Forward and appointed **Jacobs Babtie** to carry out the detailed design for Phase 1A
- ⇒ Design was completed in April 2006 and construction works awarded to **Volker Stevin** after competitive tender
- ⇒ Construction of phase 1 was complete in **December 2008**
- ⇒ Phase 2 development continues

Funding

- ⇒ Recognised in EA plans but insufficient scores to attract Defra grant for construction at the time
- ⇒ **Rotherham Council** secured most of the **£15m** package required from **Yorkshire Forward & Objective 1**
- ⇒ Supported by a **£1.5m** of the councils own funds and a **£400k** contribution from the **Yorkshire RFDC**
- ⇒ Ground breaking & sometimes controversial business case was required

Partnership with Wildlife Trust

- ⇒ Partnering with **Sheffield & Rotherham Wildlife Trust** has brought in a further **£350k** into the project
- ⇒ Site designed with their input from an early stage
- ⇒ Many hours of volunteer time and continued community engagement
- ⇒ Additions funds from **BIFFA**, **WREN** and **SITA** trusts together with **Interreg VALUE** and **Wrap**
- ⇒ These would not have been accessible without bringing in the voluntary sector
- ⇒ The wildlife trust continues to manage the site adding much more than Rotherham or the EA would have done alone



Centenary Wetland

The scheme

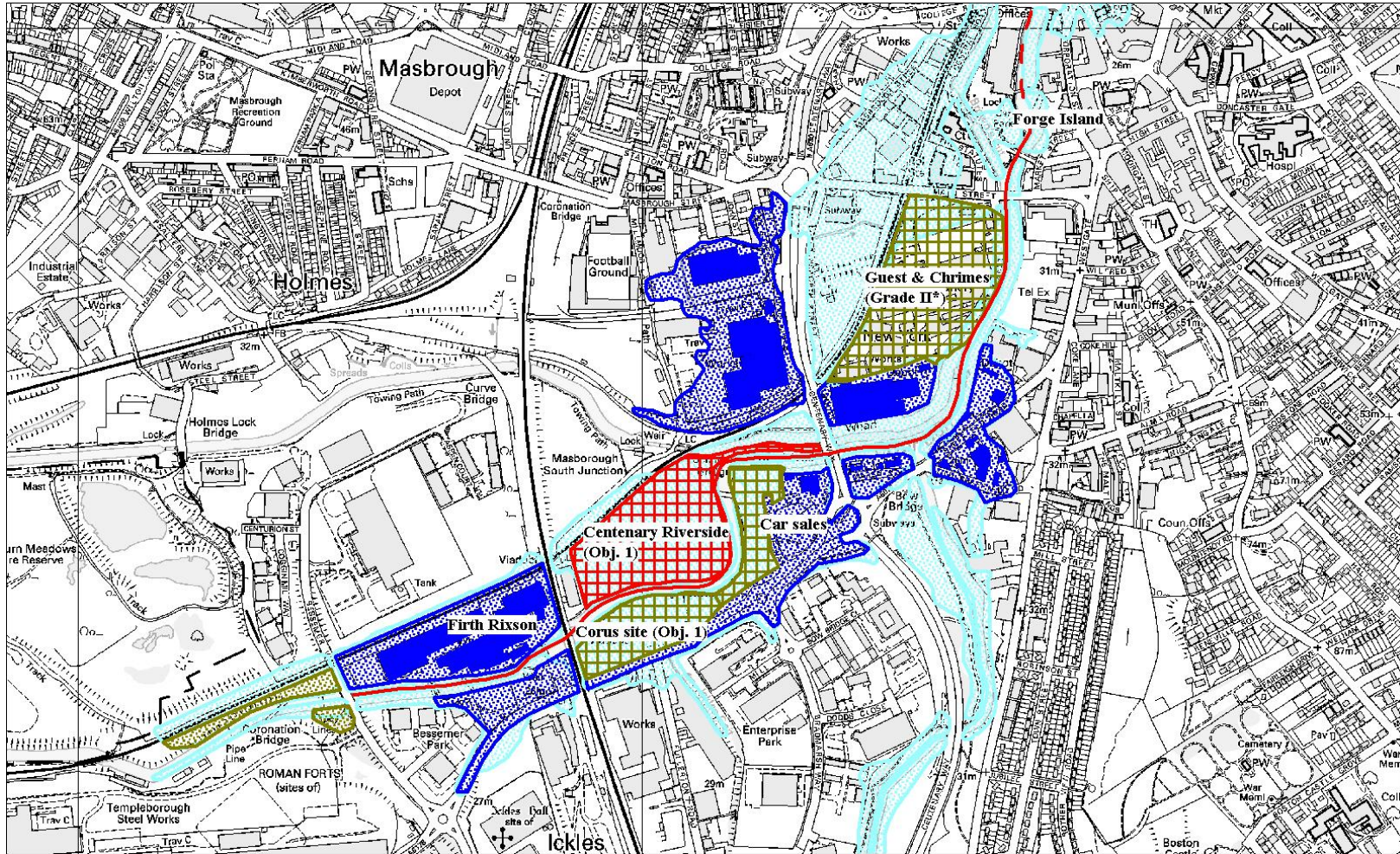

Phase 1 extents

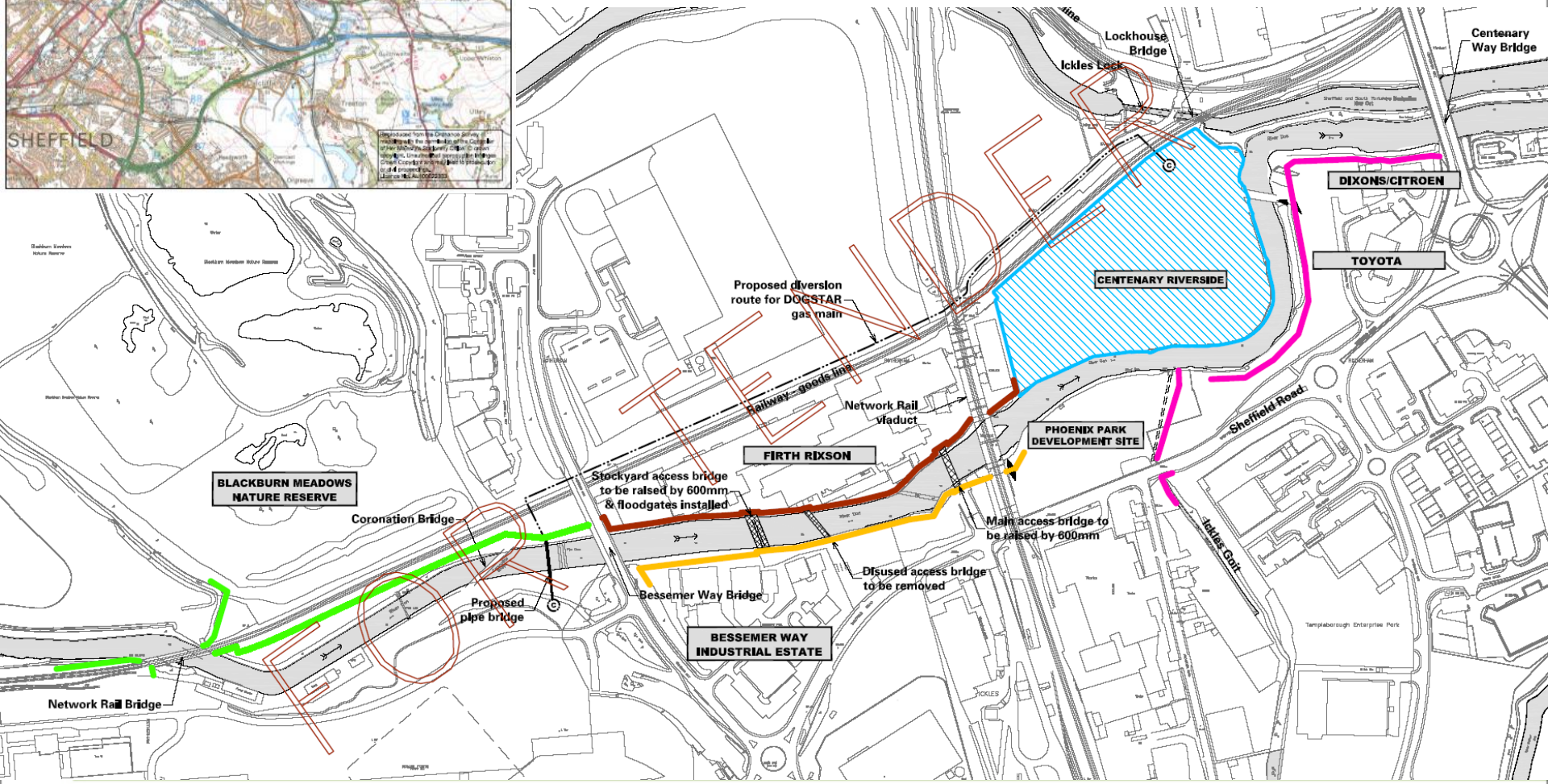
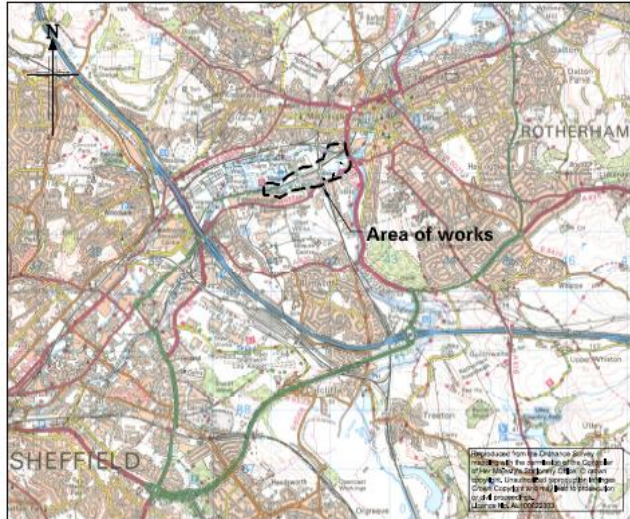

Construction



Firth Rixon site

- ➔ New defences through working sites
- ➔ Work on Network Rail land
- ➔ Bridge works (raising and removal)
- ➔ Diversion of services (including major gas main)

Construction cont.



Tight industrial sites



Removal of redundant bridges

Centenary Wetland

- ➔ Majority of materials re-used on site
- ➔ Provides compensatory storage to whole scheme
- ➔ Fish and wildlife friendly “passive” design



Sustainable Construction

- ➔ 90% of aggregates were from secondary or recycled sources (EA target 70%)
- ➔ All imported clay from reclaimed sources
- ➔ All timber from FSC certified sources
- ➔ 80,000 tonnes of materials processed for re-use on site

Successes so far...



Cllr. Gerald Smith opens the Centenary Wetland site 16th Sept 2009

Successes so far...

- ➔ **Phase 1** complete on time and on budget
- ➔ Minimal disruption to existing businesses and **no** compensation claims
- ➔ New developments in place in Phase 1 area
- ➔ Improved public access and community engagement
- ➔ Industrial heritage recognised and educational opportunities being realised

Phase 2 and beyond...

- ➔ Outline planning granted for Guest & Chrimes
- ➔ New stadium plans for Rotherham United
- ➔ New Council Offices
- ➔ Moves open up further sites for development
- ➔ Work continues

Further Info

- ➔ **Flood and Coastal Risk Management (FCRM) external contributions**
- ➔ **Policy available from our website**
- ➔ **<http://www.environment-agency.gov.uk/>**



Centenary Wetland January 2010
<http://www.rotherhamrenaissance.co.uk/>