

NOTES:
All dimensions and measurements to be checked on site prior to commencement of the Works on site and any ordering of materials.

All Works to comply with current Building Regulations, Fire Officer requirements, and the particular guidance of any other statutory and advisory bodies.

RISKS TO HEALTH & SAFETY
In addition to complying with statutory requirements, use products, methods of works and protective measures which will minimise health & safety hazards.

Access Required To The Working Zone In This Compound

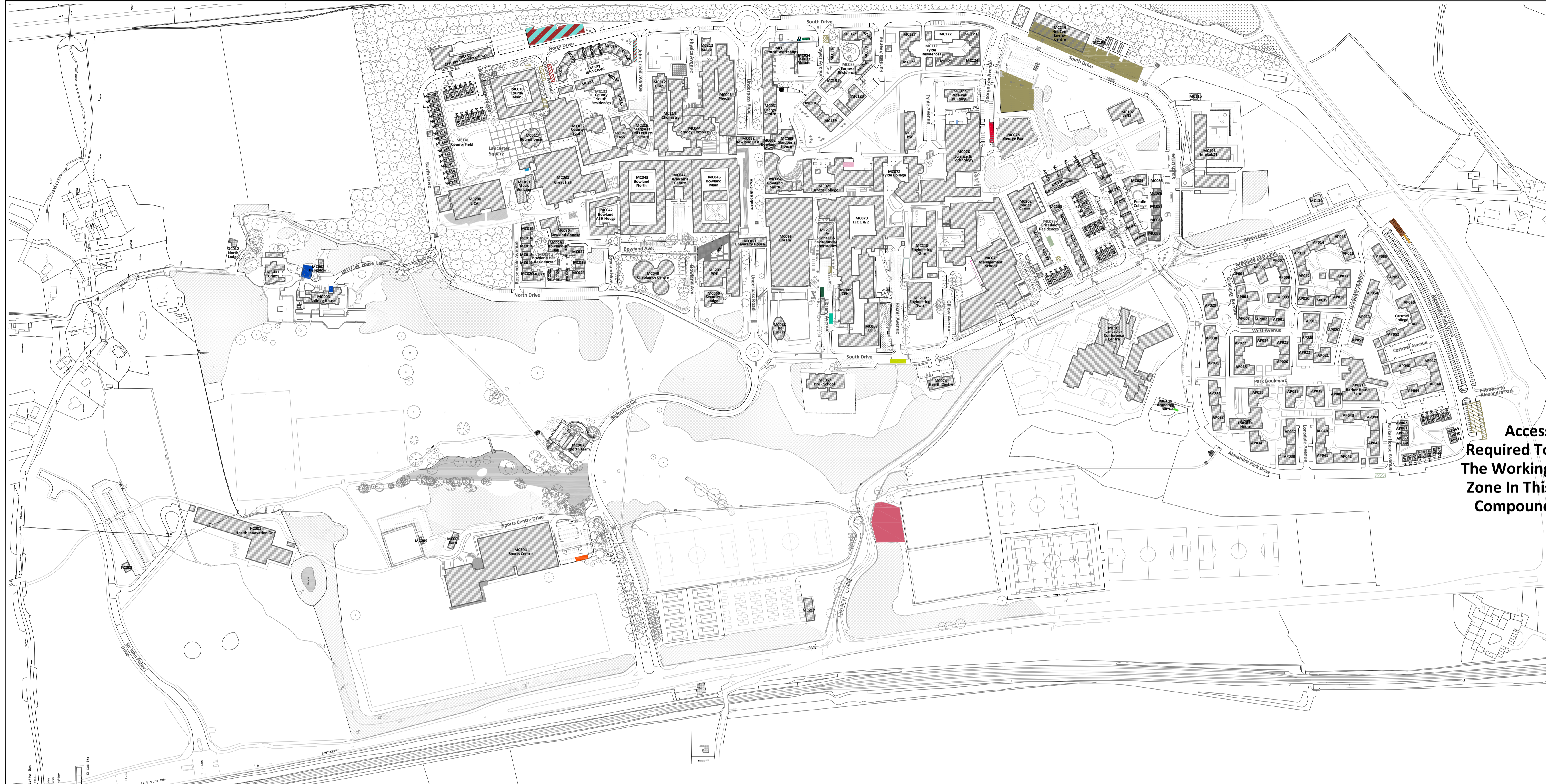

Site Compounds Key

	Mobile Generator Location	TL		Net Zero - Grizedale Res Jan - Aug '26	NS		Sports Centre Access Works May - Aug '26	DWG		UPP Works - Grizedale 11 th May - Nov '26	DT (UPP)
	DDIDI Storage	DW		Net Zero County - Scaffolding 22 nd June - 27 th Aug '26	NS		Sports Centre Astro Pitch Works March - Aug '26	DWG		UPP Works - Alex Park 11 th May - Nov '26	DT (UPP)
	LUSU Storage	J.Dav		Net Zero County - Laydown 19 th June - 10 th July '26 19 th July - 27 th Aug '26	NS		Bailrigg House External Repairs May - Nov '26	TL		Charles Carter - A Floor Alterations Aug - Dec '26	GC
	Net Zero Laydown South Campus Feb - Nov '26	NS		FST Container Dates TBC	JS		Swale Works June - July '26	ME		CEH Refurb Works June - Nov '26	CEH
	Net Zero Main Compound Nov '24 - Jan '27	NS		John Creed Res Works Spring March - June '26	HW		Furness Lift Replacement June - Sept '26	GC			
	Net Zero LEC/CEH Feb '26 - TBC	NS		John Creed Res Works Summer July - Sept '26	HW		Library Solar Louvre Redecoration Works 20 th July - 28 th Aug '26	TL			
	Net Zero Energy Centre Aug '25 - Nov '27	NS					Pre-School Window Replacement 20 th July - 28 th Aug '26	TL			

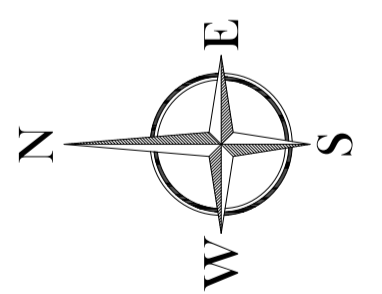

Building Name : Campus Plan		
Building Number : MC000		
Drawing Title : Site Compounds		
Drawing Number : MC000_SC		
Date : 23/06/26	Scale : NTS	Rev : EV
Paper Size : A1	Drawn By : DK	

FACILITIES
University House
Lancaster University
LA1 4YW
Tel: (01524) 593333
email: facilities.helpdesk@lancaster.ac.uk